



1500i & 2000i

What to specify...

1. Model

2. Voltage

3. Volume or Vacuum

4. Pre-filter

5. Main filter

6. Connection Kit

7. Interfacing Kit

1	2	3	1500i		2000i	
Voltage	230V ±10%	120V ±10%	400V 3ph + N	220V 3ph		
Volume Control	0LX1510D	0LX1511D	0LX2010D	0LX2011D		
Vacuum Control	021820iD	021821iD	022120iD	022121iD		
Wattage	1.5 kW	1.5 kW	3.0 kW	3.0 kW		
Frequency	50Hz / 60 Hz	50Hz / 60 Hz	50Hz / 60 Hz	50Hz / 60 Hz		
Cabinet height (inc castors)	1400 mm	1400 mm	1400 mm	1400 mm		
Cabinet width (not inc hose)	725 mm	725 mm	725 mm	725 mm		
Cabinet depth (not inc hose)	726 mm	726 mm	726 mm	726 mm		
Cabinet weight (inc filters)	150 Kg	150 Kg	150 Kg	150 Kg		
Construction	Precision engineered brushed stainless steel units. High performance continuous run brushless motors. Mounted on castors for mobility.					

4

Labyrinth Pre-filter



Options:

F6 (std)

F8/F9 Composite*

Code:

111037

111099

PVC Options:

Chemical Absorbant

Pad (Pack of 4)

*Use F8/F9 Labyrinth bags for PVC

Code:

200281

5

Main filter



Options:

HEPA/Chemical (std)

HEPA/Twin Chemical

HEPA/Chemical Cleanroom*

Chemical

Code:

110615

110614

110632

110610

* Use in combination with 111099

6

Connection Hose Kit (Optional)

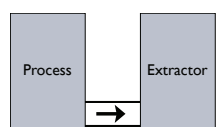

PAGE 26-28

For PVC applications please contact us.

7

Machine Interfacing (Optional)



Allows the Purex system to interface with a piece of equipment connected to it.

- **Start/Stop Control:** Extraction unit starts/stops when a connected piece of equipment is switched ON/OFF.
- **Filter Blocked Warning:** A signal is sent to a connected piece of equipment to trigger an alert or to shut it down.
- **Remote ON/OFF Switch:** 5M cable & switch

See PAGE 34



Optional Clean Air Cowl - 640002

PVC Version Available

Air Compressor Available For This Model

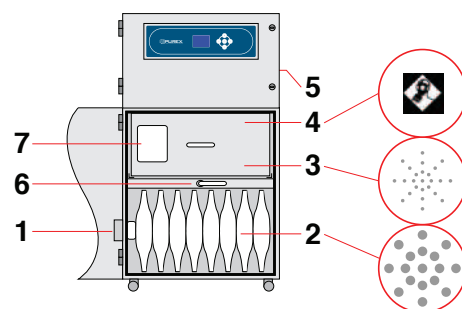

Legend:

- 1) Air inlet - 150mm safe seal.
- 2) Pre-filter.
- 3) Main Filter (HEPA location). †
- 4) Main Filter (Carbon location). †
- 5) Clean air returned to workplace.
- 6) Filter locking handle.
- 7) Filter identification label.

All machines are mounted on four castors for increased mobility.

† Standard Filter Only

Digital Control System

A dedicated control, monitoring and display system unique to Purex fume extractors. All functions are fully automatic, all the user has to do is set the appropriate airflow on installation. The features of this system are designed to:

- Lower energy consumption by using variable speed motors and automatic flow control.
- Increase filter life by using the optimal extraction rate.
- Further protect people by constantly monitoring exhaust emissions.
- Interface with other equipment e.g. a laser.
- Maintain a constant extraction rate to prevent fume escape or damage to equipment.

System Features...

- Automatic electronic flow control - maintains a constant extraction rate even as the filter blocks
- Adjustable airflow
- Clear and informative graphic display
- Gas and Particle Sensors on the exhaust
- Low capital and running costs
- Quick change patented Labyrinth pre-filters deliver longer filter life
- Submicronic (HEPA) filtration removes 99.997% of particles down to 0.3 microns
- Activated carbon filtration removes harmful gas
- Simple to install and quiet in operation
- Easy to relocate and precision made from stainless steel

Includes:

- 1 x Main filter
- 1 x Labyrinth Pre-filter
- 1 x Power cable (no plug)

Accessories

Please see the accessories section at the back of this brochure.